

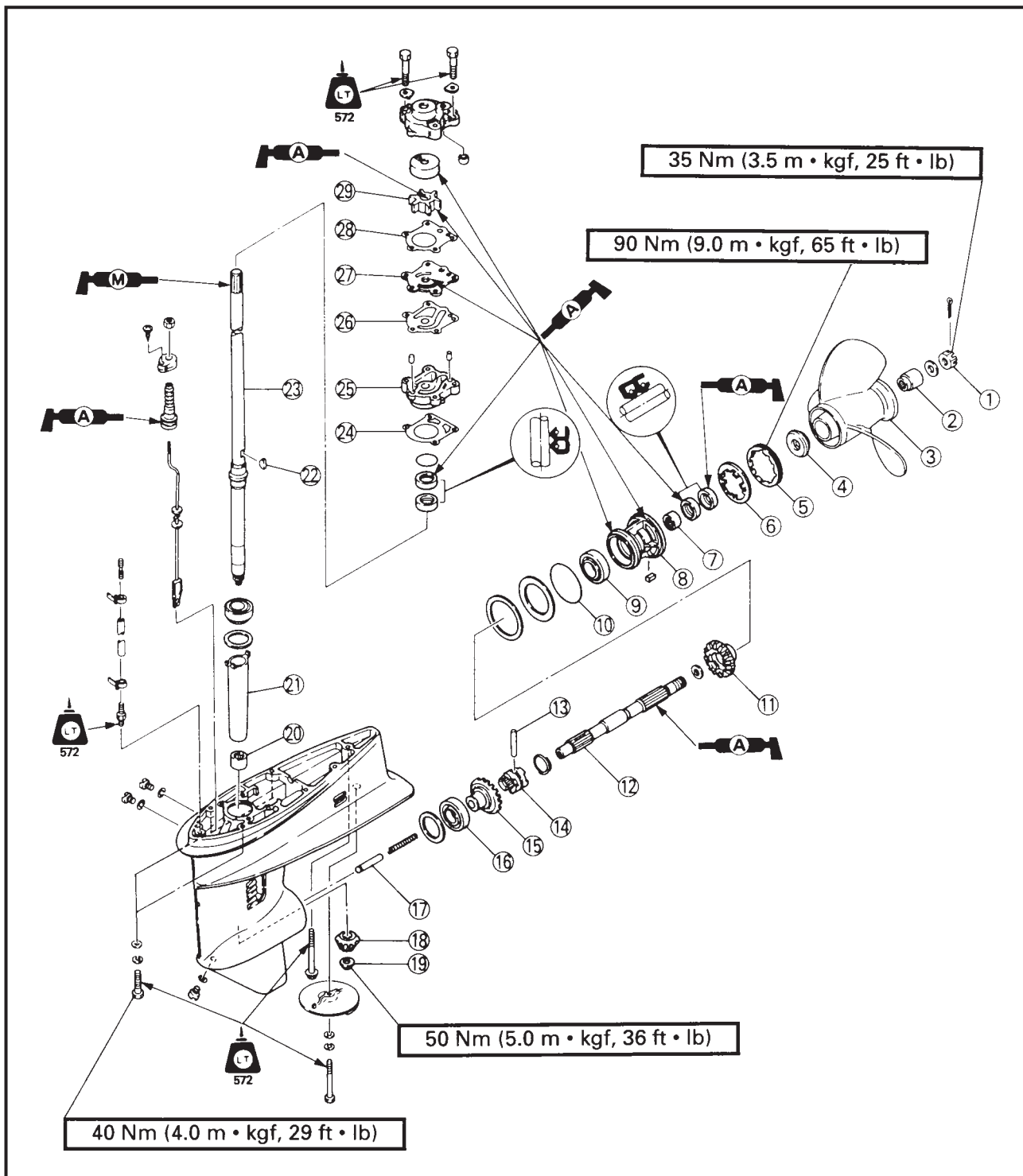

# EXPLODED DIAGRAM

- |                   |                   |                                |
|-------------------|-------------------|--------------------------------|
| ① Nut             | ⑪ Reverse gear    | ⑳ Drive shaft sleeve           |
| ② Spacer          | ⑫ Propeller shaft | ㉑ Woodruff key                 |
| ③ Propeller       | ⑬ Cross pin       | ㉒ Drive shaft                  |
| ④ Spacer          | ⑭ Clutch dog      | ㉓ Water pump gasket            |
| ⑤ Ring nut        | ⑮ Forward gear    | ㉔ Water pump housing           |
| ⑥ Claw washer     | ⑯ Bearing         | ㉕ Cartridge outer plate gasket |
| ⑦ Needle bearing  | ⑰ Shift plunger   | ㉖ Cartridge outer plate        |
| ⑧ Bearing housing | ⑱ Pinion          | ㉗ Water pump gasket            |
| ⑨ Bearing         | ㉒ Pinion nut      | ㉘ Impeller                     |
| ⑩ O-ring          | ㉓ Needle bearing  |                                |

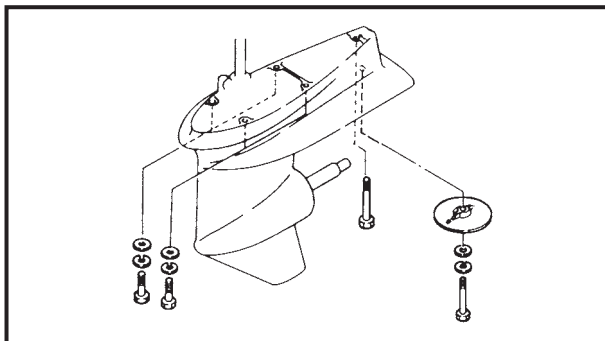

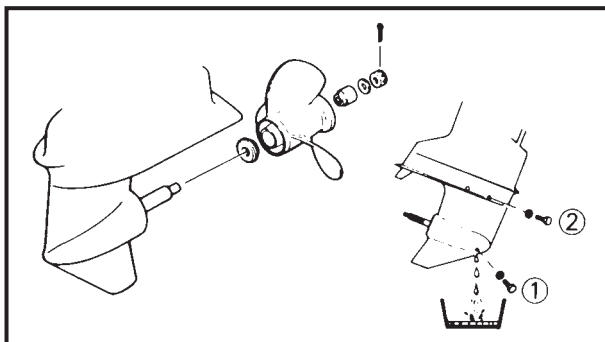

120002-0

## PREPARATION FOR REMOVAL

1. Remove the nut and washer, and remove the propeller and spacer from the propeller shaft.
2. Drain the gear oil.

### NOTE:

When draining the gear oil, tilt up the engine. If not, the oil cannot be drained completely. Remove the drain plugs in the order of ① and ②.

130000-0

## REMOVAL

1. Disconnect the link from the shift rod.
2. Remove the bolts and remove lower unit complete.

Note the following point:

- One installation bolt is behind the trim-tab; therefore first remove the trim-tab, and then remove the installation bolt.

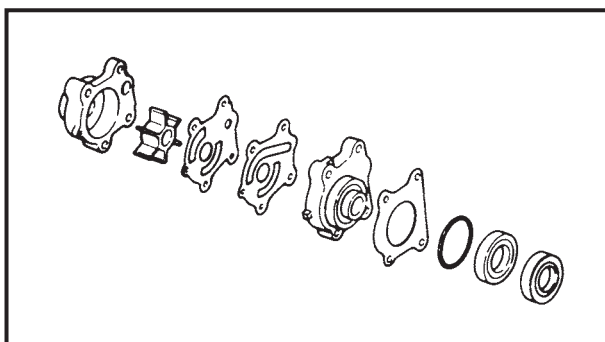

14000B-0

## DISASSEMBLY

1. Referring to the exploded diagram, remove the following parts.

- Water pump housing
- Impeller and woodruff key
- Oil seal

Using special service tool.



**Slide hammer set:**

**YB-6096**

**Stopper guide plate:**

**90890-06501**

**Bearing puller:**

**90890-06535**

**Stopper guide stand:**

**90890-06538**

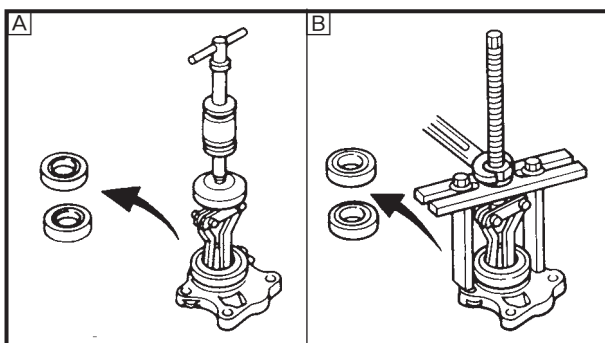

**A** For USA and CANADA

**B** Except for USA and CANADA

- Shift-rod