

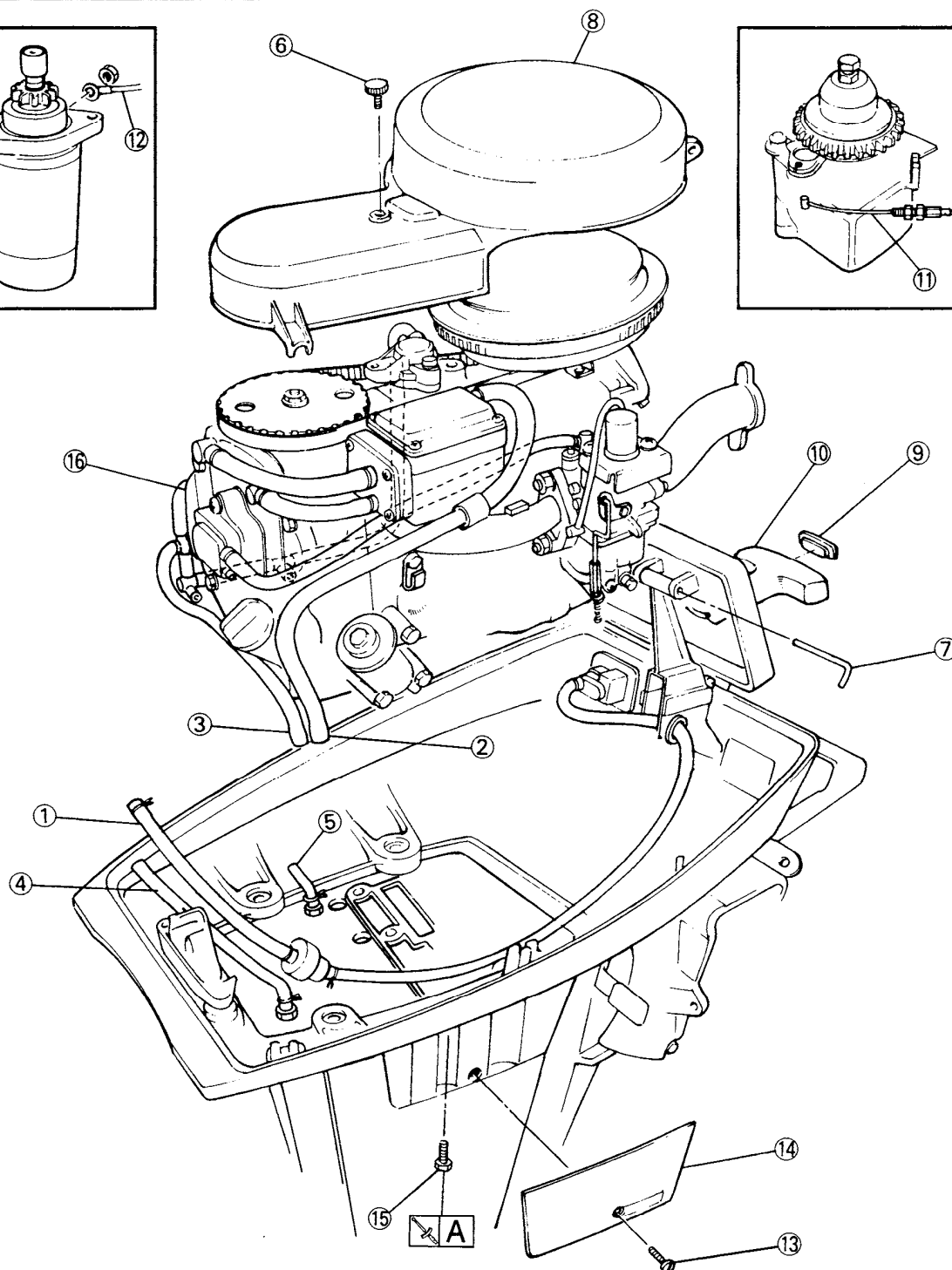

POWER UNIT REMOVAL **PREPARATION FOR REMOVAL**

- * Drain the engine oil.
- * Remove the top cowling.
- * Remove the terminal cover.
- * Disconnect the oil lamp lead.
- * Remove the oil level gauge.
- * Disconnect the stop switch leads.

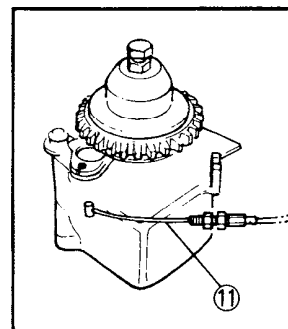
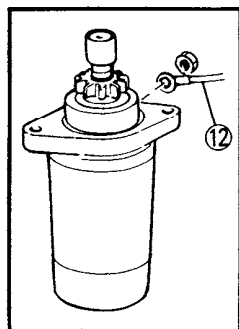

A 21 Nm (2.1 m • kg, 15 ft • lb)

NOTE ON REMOVAL AND REASSEMBLY

- After removing the power unit, protect the lubricating system, including the oil pan and relief valve, from dust and dirt.

Extent of removal: ① Power unit removal

Extent of removal	Order	Part name	Q'ty	Remarks
	1	Fuel hose	1	
	2	Blow by hose	1	
	3	Water hose	1	
	4	Water hose	1	
	5	Water hose	1	
	6	Screw	1	
	7	Hinge pin	1	
	8	Flywheel cover	1	
	9	Grip cover	1	Recoil starter model only Refer to "REMOVAL POINTS".
	10	Starter grip	1	
	11	Neutral starting device cable	1	
	12	Battery lead	1	Electric starter model only
	13	Screw	2	
	14	Apron	2	
	15	Bolt	6	
	16	Power unit	1	

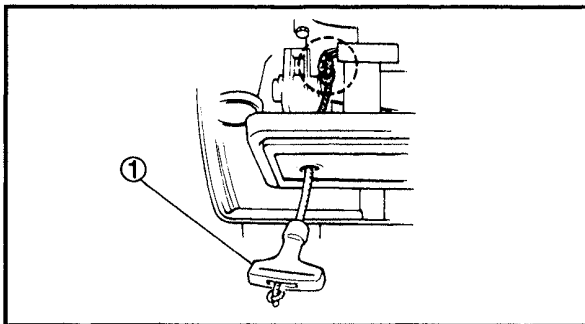
REMOVAL POINTS
STARTER GRIP

1. Remove:
 - Starter grip ①

NOTE:

When removing the starter grip, pull out the starter rope and make a knot in the rope so that the rope is not pulled into the starter.

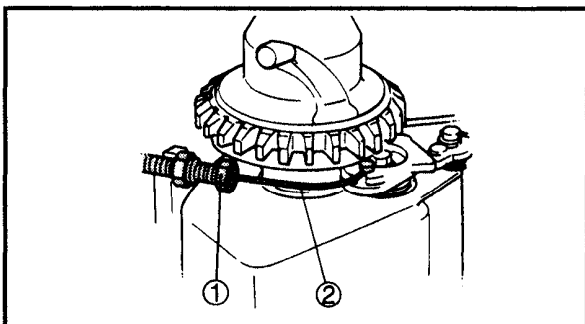
STOP WIRE

1. Remove:
 - Lock nut ①
 - Start-in gear protection cable ②

NOTE:

Do not remove the stop wire before removing the starter grip, or it is impossible to pull out the starter rope when removing it.

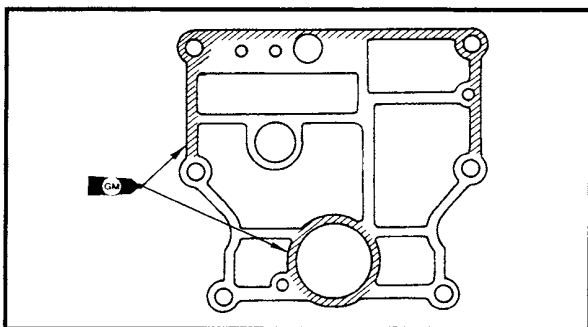

INSTALLATION POWER UNIT

1. Apply:
 - Gasket Maker
 Onto both faces of the gasket.

NOTE: _____
Clean the contacting surface of crankcase.

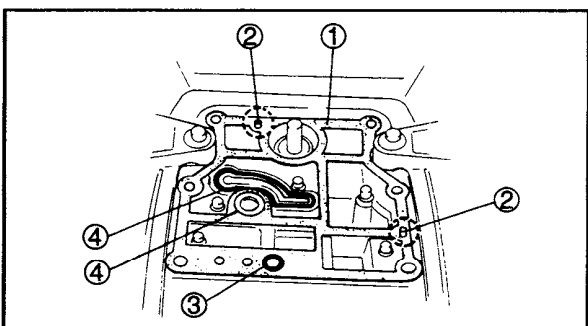

2. Install:
 - Gasket ①
 - Dowel pin ②
 - O-ring ③
 - Seal ④

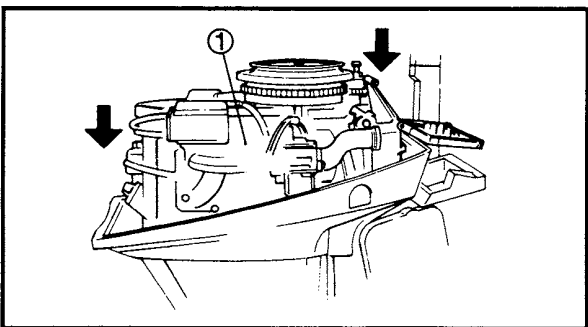

3. Install:
 - Power unit ①

NOTE: _____
● If the crankshaft splines do not mesh with the drive shaft splines, turn the flywheel a little so that they can mesh.
● Use care not to pinch the lead and pipe.

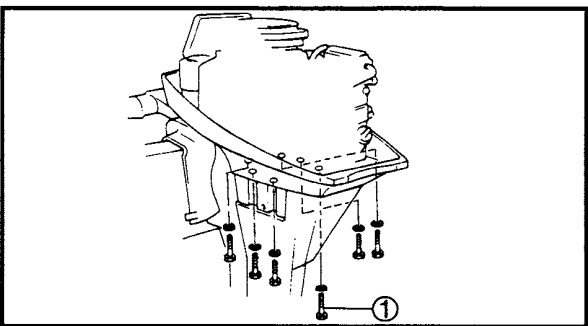

4. Install:
 - Bolt ①



Bolt:
21 Nm (2.1 m • kg, 15 ft • lb)

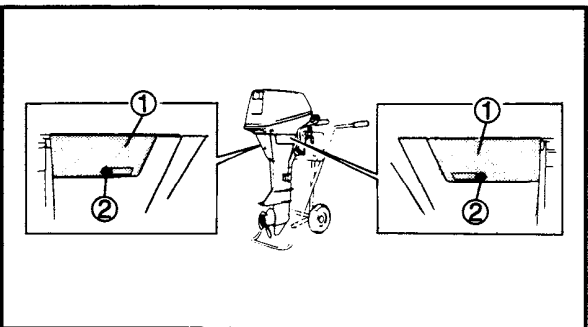

5. Install:
 - Apron ①
 - Screw ②

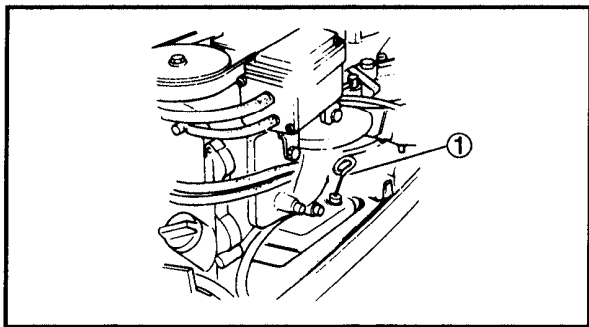

6. Install:

- Oil level gauge ①

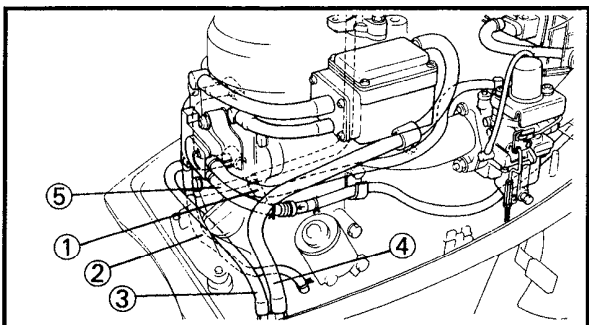

7. Connect:

- Water hose ①
- Water hose ②
- Water hose ③
- Blow by hose ④
- Fuel hose ⑤

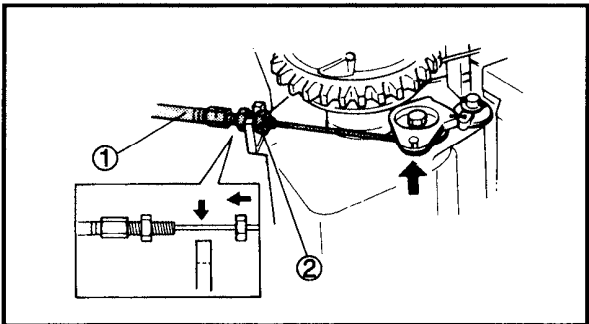

RECOIL STARTER

1. Install:

- Start-in gear protection wire ①
- Lock nut ②

2. Adjust:

- Start-in gear protection cable length
- Refer to page 3-11.

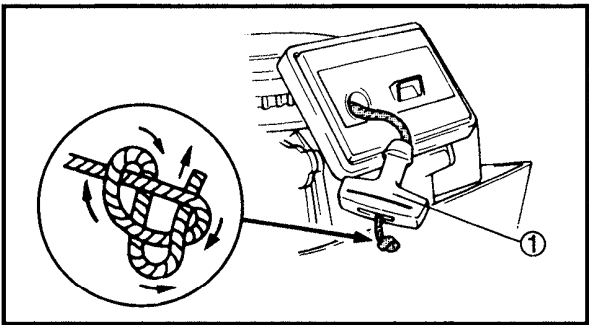

3. Install:

- Starter grip ①

NOTE:

Pass the starter rope through the front panel and starter grip, and make a knot in the end of the rope, then put it into the starter grip.

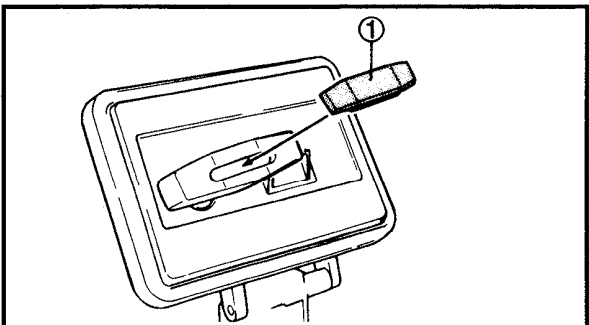

4. Install:

- Grip cover ①

NOTE:

After installing the grip cover, untie the knot, and let the rope wind around the starter.

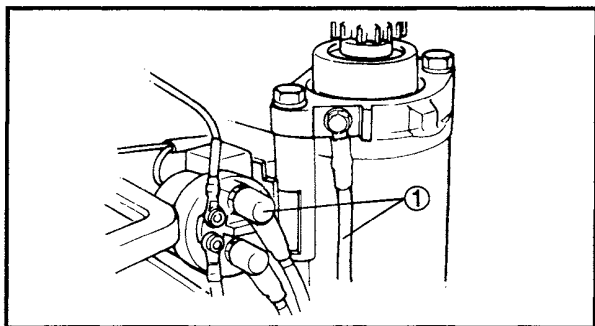

BATTERY LEAD

1. Install:

- Battery lead ①
- Refer to pages 8-2 ~ 8-4.

NOTE:

Connect the battery lead to both of the starter motor and starter relay.

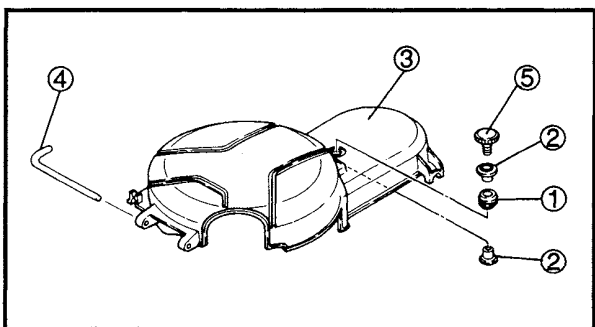

FLYWHEEL COVER

1. Install:

- Grommet ①
- Collar ②
- Flywheel cover ③
- Hinge pin ④
- Screw ⑤

NOTE:

Secure the L-shaped portion to the holder.

2. Install:

- Electrical leads
 - Terminal cover
 - Screw
- Refer to pages 8-1 ~ 8-4.

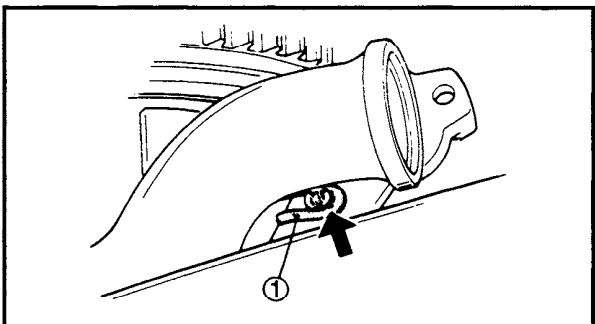

3. Connect:

- Throttle link ①

4. Adjust:

- Throttle link length
- Refer to page 3-14.

CYLINDER, PISTON AND CRANKSHAFT PREPARATION FOR REMOVAL

- * Remove the power unit.
- * Remove the following parts:
 - CDI unit
 - Ignition coil
 - Rectifier regulator

A	1st: 6 Nm (0.6 m • kg, 4.3 ft • lb) 2nd: 12 Nm (1.2 m • kg, 8.7 ft • lb)
B	23 Nm (2.3 m • kg, 17 ft • lb)
C	1st: 15 Nm (1.5 m • kg, 11 ft • lb) 2nd: 30 Nm (3.0 m • kg, 23 ft • lb)
D	100 Nm (10.0 m • kg, 72 ft • lb)

