

# SECTION 2

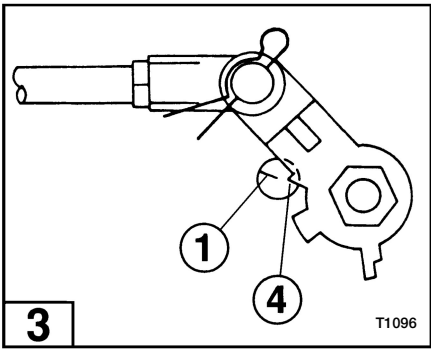

Model	Throttle Position	Aperture Setting
<b>1</b> 40 / 50	Fully OPEN	Marks <b>1</b> and <b>2</b> aligned.
<b>2</b> 60 / 70	Fully CLOSED	Marks <b>1</b> and <b>3</b> aligned.
<b>3</b> 70	Fully OPEN*	Marks <b>1</b> and <b>4</b> aligned.
<b>4</b> 90 / 115 / 120 / 140	Fully CLOSED	Marks <b>1</b> and <b>5</b> aligned.
<b>5</b> 90	Fully OPEN*	Marks <b>1</b> and <b>6</b> aligned.

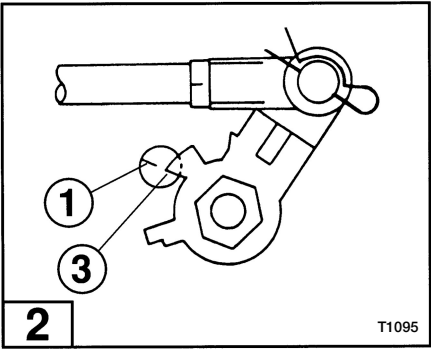
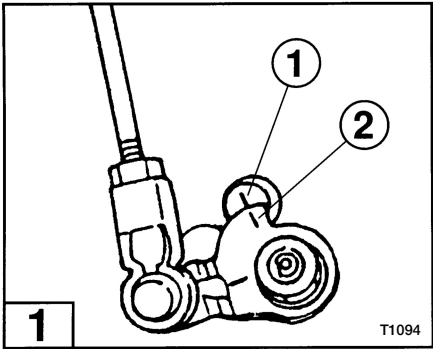
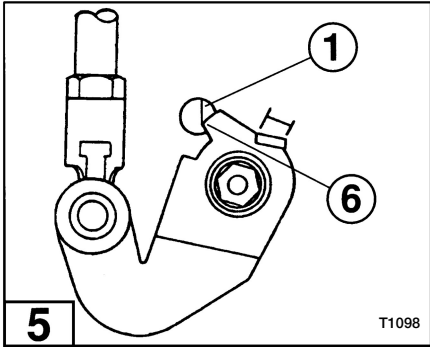
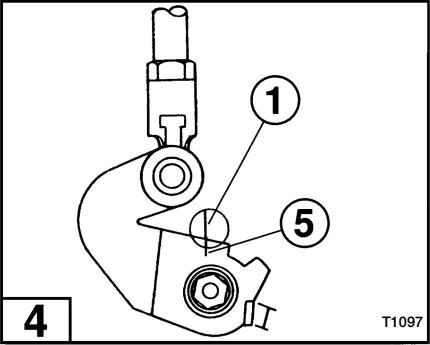

\*Verify only adjustment made in CLOSED position.