

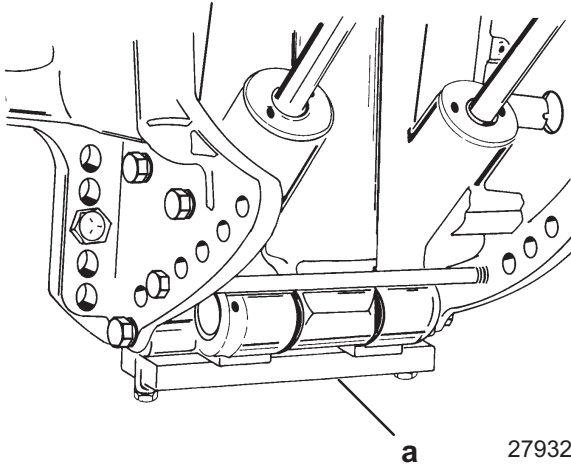

Anode Plate

Anode plate is a self-sacrificing alloy plate that is consumed gradually by corrosion while providing protection to the midsection and power trim from galvanic corrosion. Replace anode plate when it is 50% consumed.



a - Anode Plate

IMPORTANT: Do not paint or place protective coating on anode plate, or corrosion protection function will be lost.

Trim Indicator Gauge

A Quicksilver Trim Indicator Gauge accessory kit is available for the power trim sender (if not previously installed).

Check, Fill and Purge - Power Trim System

TO CHECK:

CAUTION

Tilt outboard to full “Up” position and engage tilt lock lever before checking fluid level. System is pressurized. Extend trim and tilt rams fully to depressurize system.

Remove fill plug and O-ring. System is full when oil level is present at filler hole. Tighten fill plug securely.

NOTE: Automatic Transmission Fluid (ATF) Type F, FA, Dexron II or Dexron III may be used.

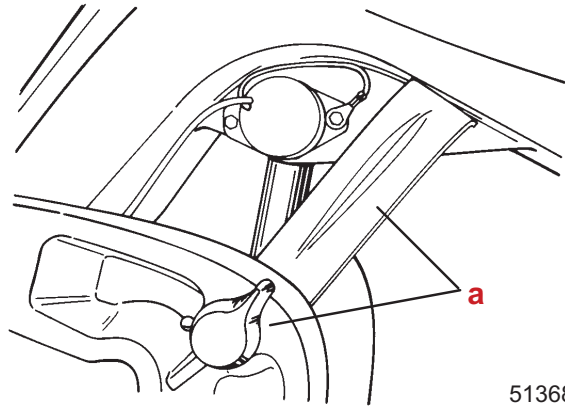

a - Tilt Lock Lever

51368

TO FILL:

IMPORTANT: This trim system is pressurized. Remove “Fill” plug only when outboard is tilted to the full “Up” position or the trim/tilt rams are fully extended. Retighten “Fill” plug before tilting outboard down or retracting tilt/trim rams. Remove “Fill” plug and O-ring. System is full when oil level is present at fill hole. Tighten “Fill” plug securely.

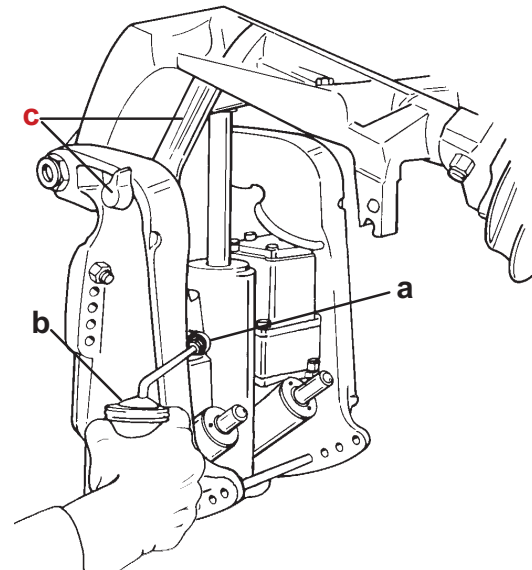

- a - Fill Plug and O-ring (remove to fill system, tighten securely)
- b - Oil Can (fill system with Quicksilver Power Trim and Steering Fluid)
- c - Tilt Lock Lever (engage to support engine in “Up” position)

51344

TO PURGE:

IMPORTANT: Fill plug and O-ring must be tightened securely before purging system.