

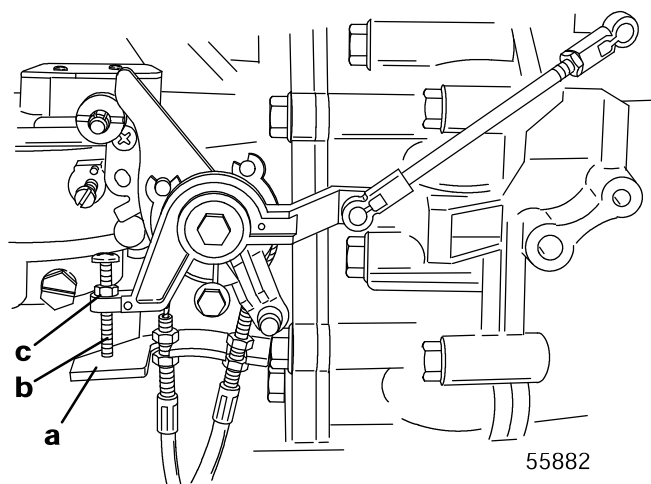

ADJUSTING MAXIMUM SPARK ADVANCE

IMPORTANT: Setting the idle timing is required before adjusting the maximum spark advance.

16. Turn engine off.
17. Position twist grip or remote control lever to maximum throttle opening, (wide open throttle).
18. Loosen jam nut and turn screw counter-clockwise until screw no longer makes contact with throttle bracket platform.
19. Turn screw in (clockwise) until screw just makes contact with the throttle bracket platform and then give screw one (1) additional turn clockwise and tighten jam nut.



- a - Throttle Bracket Platform
b - Screw
c - Jam Nut

20. With engine idling at specified R.P.M. in "FORWARD" gear, loosen cam follower screw and place cam follower roller against throttle cam and tighten cam follower screw. Cycle the throttle mechanism through part throttle and back to idle. Recheck in gear idle R.P.M..

NOTE: When setting idle mixture, DO NOT adjust leaner than necessary to attain reasonably smooth idling. When in doubt, stay to the slightly rich side of highest R.P.M..

21. Adjust carburetor for best performance, after clearing the engine. With engine running at idle speed in "FORWARD" gear, turn mixture screw "IN" (clockwise) until engine starts to lose R.P.M., fire unevenly, and or misfires. Back out 1/4 turn or more. (See General Specifications for minimum and maximum adjustment).
22. Check for too lean of mixture on acceleration. (Engine will "hesitate" or "stall" on acceleration). Readjust mixture if necessary.
23. Re-adjust idle speed screw in "FORWARD" gear to specification.

Shift Link Rod Installation and Adjustment to Engine

Install cables into the remote control following the instructions provided with the remote control.

NOTE: Install the shift cable to the engine first. The shift cable is the first cable to move when the remote control handle is moved out of neutral.

1. Position remote control and outboard into neutral.

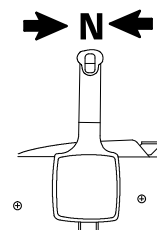

2. Measure distance "a" between mounting pin and middle of the barrel holder.

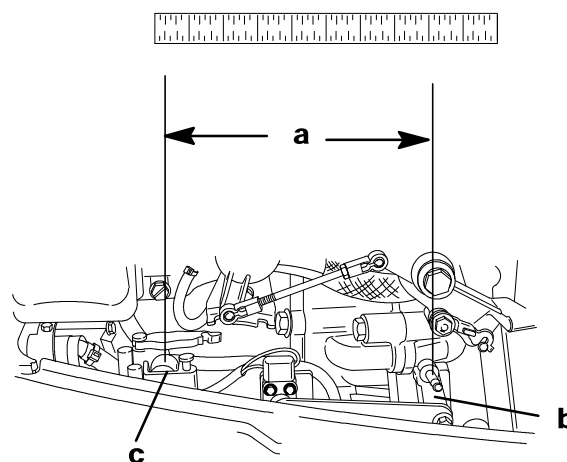

- a - Distance Between Pin and Middle of Barrel Holder
b - Mounting Pin
c - Barrel Holder



3. Push-in on the cable end until resistance is felt. Adjust the cable barrel (b) to attain the measured distance "a" taken in Step 2.
4. Place cable barrel into the bottom hole in the barrel holder. Fasten cable to pin with retainer.

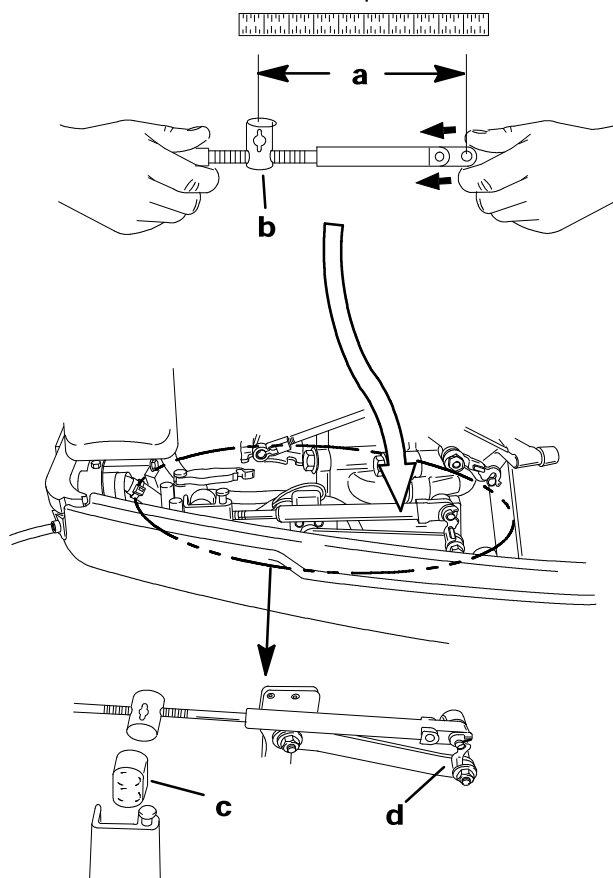

- a - Move Cable Barrel To Attain The Measured Distance Taken In Step 2
 b - Cable Barrel
 c - Barrel Holder - Place Barrel Into Bottom Hole
 d - Retainer

5. Check shift cable adjustments as follows:

- a. Shift remote control into forward. The propeller shaft should be locked in gear. If not, adjust the barrel closer to the cable end.
- b. Shift remote control into neutral. The propeller shaft should turn freely without drag. If not, adjust the barrel away from the cable end. Repeat steps a and b.
- c. Shift remote control into reverse while turning propeller. The propeller shaft should be locked in gear. If not, adjust the barrel away from the cable end. Repeat steps a thru c.
- d. Shift remote control back to neutral. The propeller shaft should turn freely without drag. If not, adjust the barrel closer to the cable end. Repeat steps a thru d.

Throttle Cable Installation

1. Position remote control into neutral.

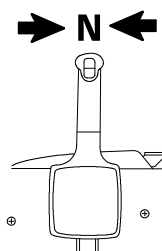

2. Install cable to the throttle lever. Secure with retainer.

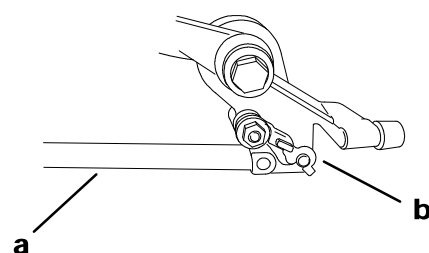

- a - Throttle Cable
 b - Retainer

3. Adjust the cable barrel so that the installed throttle cable will hold the throttle arm against the stop.

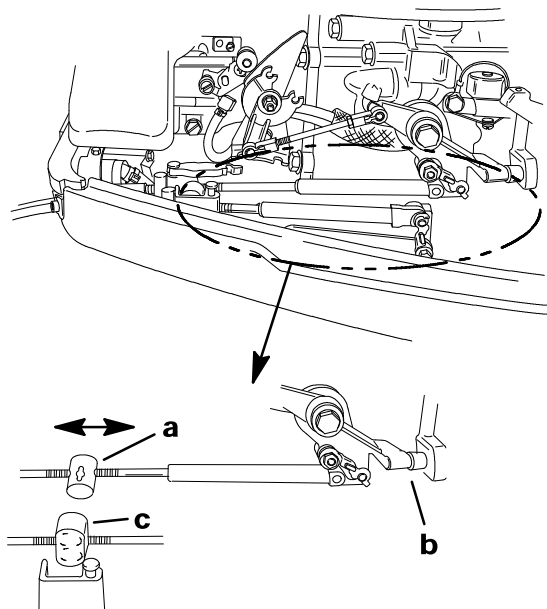

- a - Cable Barrel - Adjust To Hold Throttle Arm Against Stop
 b - Throttle Arm
 c - Barrel Holder - Place barrel Into Top Hole



4. Check throttle cable adjustment as follows:

- a. Shift outboard into gear a few times to activate the throttle linkage. Make sure to rotate the propeller shaft while shifting into reverse.

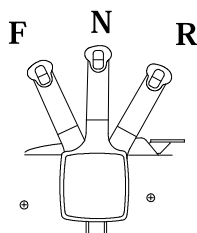

- b. Return remote control to neutral. Place a thin piece of paper between throttle arm and idle stop. Adjustment is correct when the paper can be removed without tearing, but has some drag on it. Readjust cable barrel if necessary.

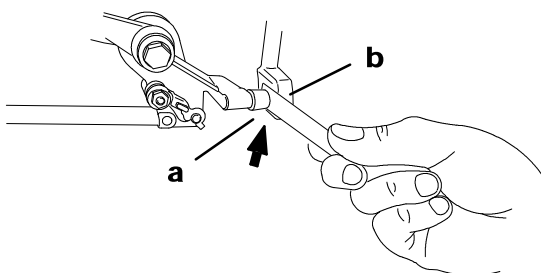

a - Throttle Arm
b - Idle Stop

5. Lock the barrel holder in place with the cable latch.

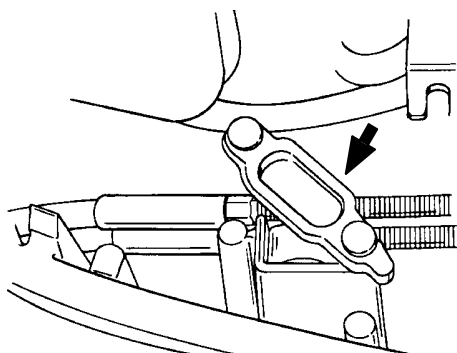

Oil Pump Adjustment

While holding throttle arm at idle position, adjust length of link rod so the stamped mark of oil pump body aligns with stamped mark of oil pump lever.

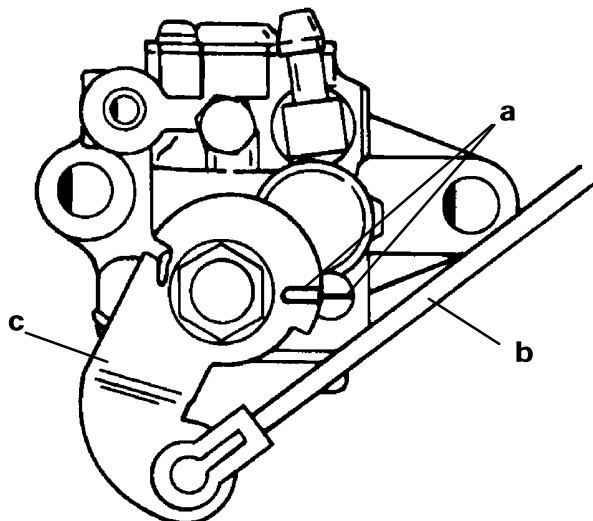

52365

a - Alignment Mark
b - Link Rod
c - Oil Pump Lever