

Class B AIS Transceiver

QUICK START GUIDE



For full instructions on how to install and use your AIS Transceiver please refer to the product manual.

Step 1 – Install the Transceiver

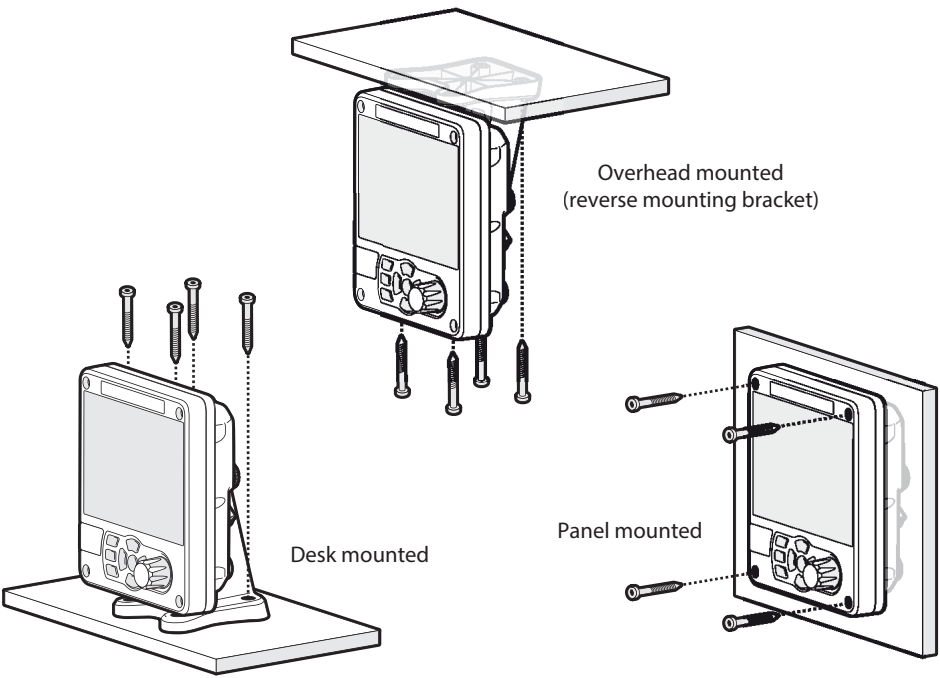

Step 2 – Install the Antennas

GNSS antenna should be at least 5m (16ft) from RADAR or satellite communication antennas. It should also be away from the RADAR beam path and mounted on a rigid surface.

VHF antenna should be at least 3m (10ft) from other transmitting radio, satellite and RADAR antennas.

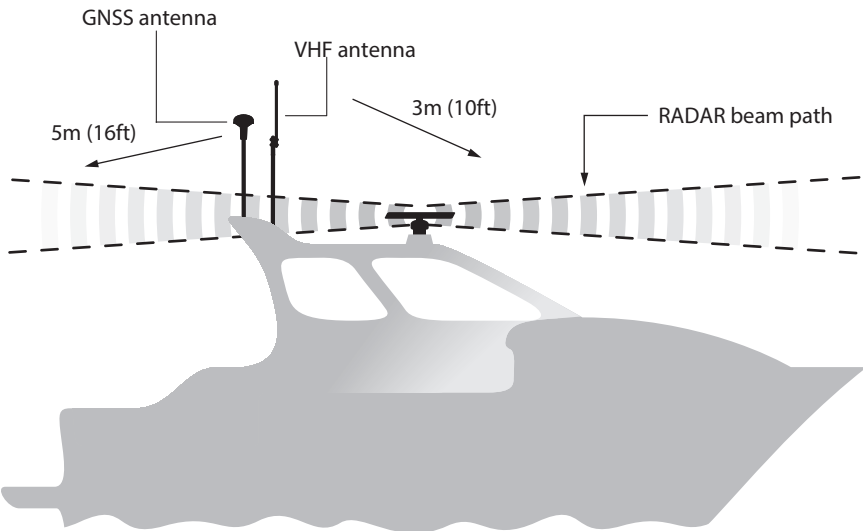

What's in the box?

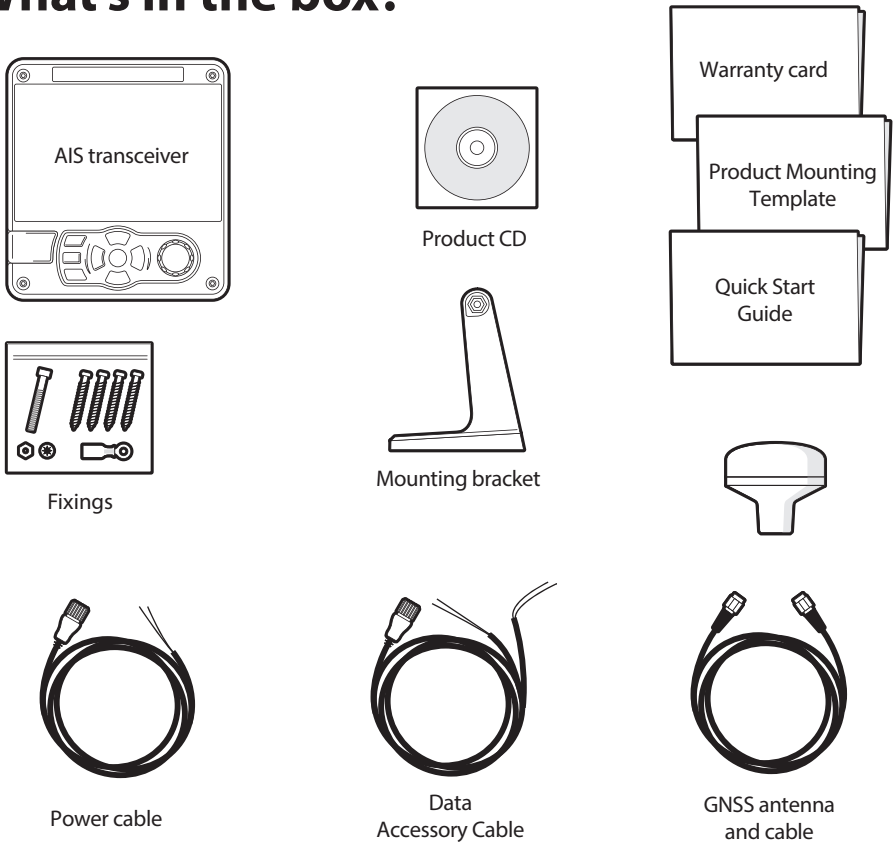

What do I need?

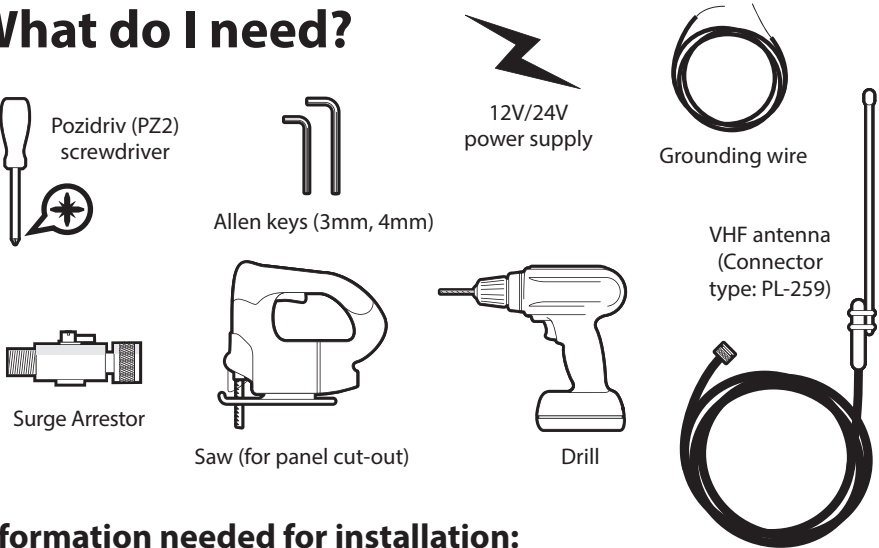

Information needed for installation:

MMSI number (9 digits):

Vessel name:

Vessel callsign:

Vessel dimensions and GNSS antenna position:

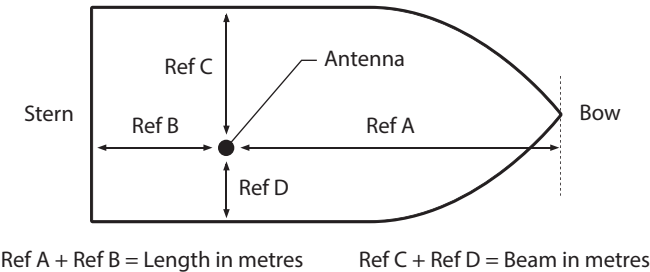

Front panel controls

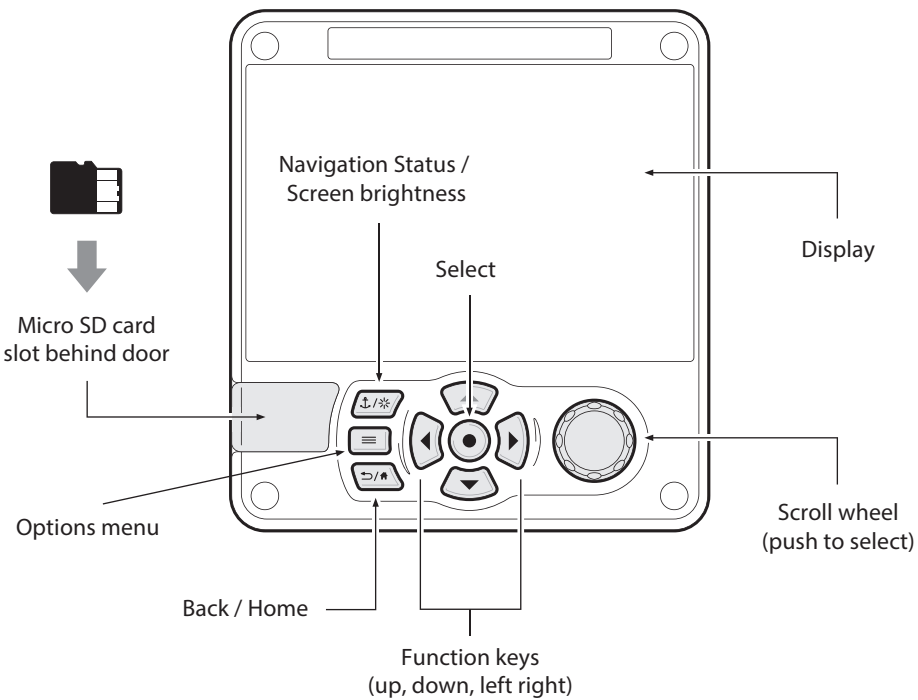

Step 3 – Connecting the transceiver

NOTE: Numbers and tables refer to connector pins on unit

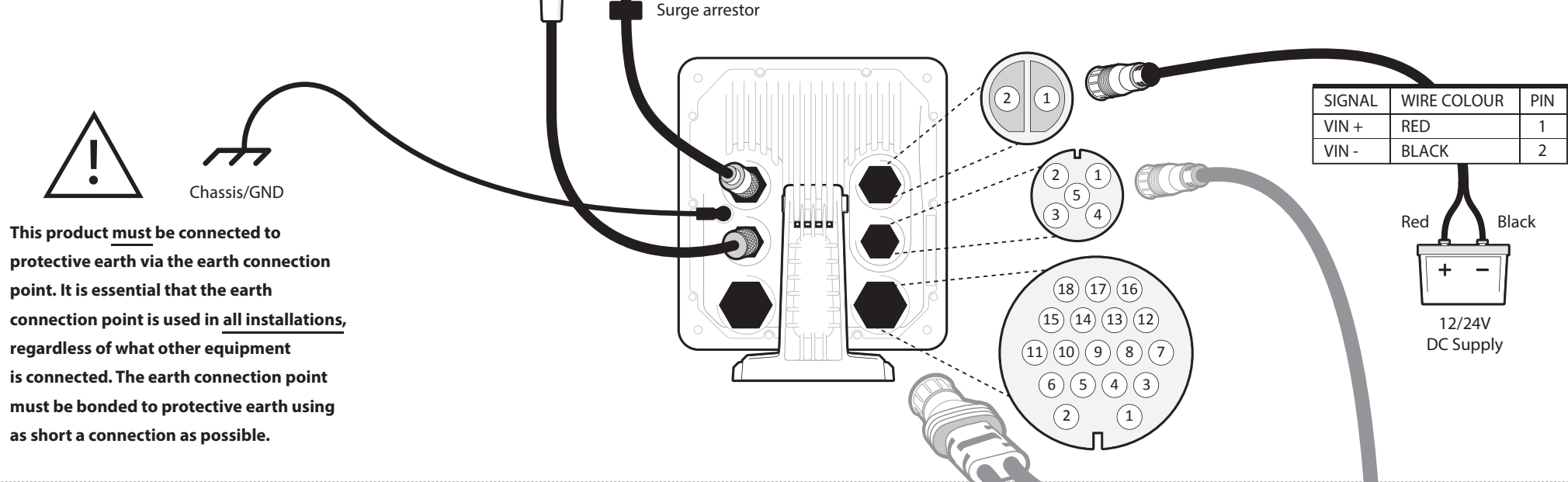

Optional connections

DESCRIPTION	PORT NAME IN MKD	WIRE COLOUR	PIN	FUNCTION
NMEA0183 PORT 1 COM	EXTERNAL DISPLAY 2	BLACK	1	HIGH SPEED NMEA0183 OUTPUT (38,400 baud) INTENDED FOR CHART PLOTTERS
NMEA0183 PORT 1 Tx+	EXTERNAL DISPLAY 2	BLUE/WHITE	3	
NMEA0183 PORT 1 Tx-	EXTERNAL DISPLAY 2	WHITE/BLUE	4	

DESCRIPTION	PORT NAME IN MKD	WIRE COLOUR	PIN	FUNCTION
NMEA0183 PORT 2 Rx+	BI-DIRECTIONAL SERIAL PORT	RED/WHITE	6	CAN BE SET TO LOW SPEED (4,800 baud) INTENDED FOR CONNECTION TO OTHER NMEA0183 COMPATIBLE SENSORS FOR MULTIPLEXING OF DATA TO THE CHART PLOTTER
NMEA0183 PORT 2 Rx-	BI-DIRECTIONAL SERIAL PORT	ORANGE/WHITE	10	
NMEA0183 PORT 2 COM	BI-DIRECTIONAL SERIAL PORT	BLACK	11	

SIGNAL	PIN
N2K_NET_SHIELD	1
N2K_NET_S	2
N2K_NET_C	3
N2K_NET_H	4
N2K_NET_L	5

An optional junction box, USB cable and 14/18 way data cables are available to assist with wiring to sensors and displays

Step 4 – Quick Start Sequence

